

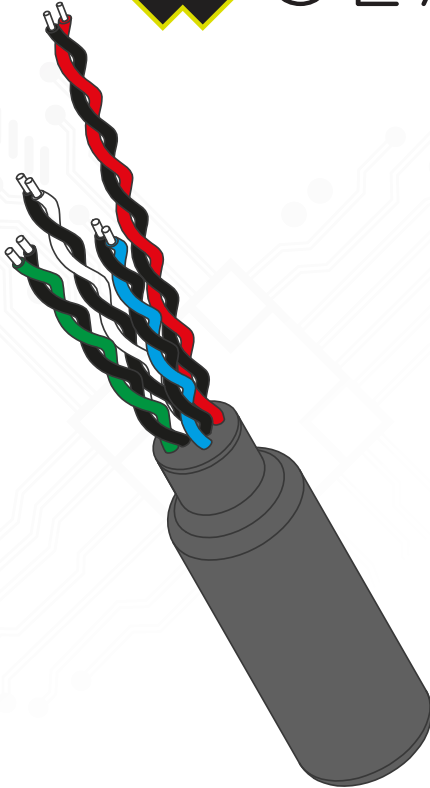

GLAS



GUARDIAN

WIRELESS
SAFETY 

MULTI ENGINE CONNECTOR



WIRING DIAGRAM

Waterproof connections:

All connections should use marine grade, waterproof connection methods

BLUE, GREEN and WHITE wires are signal wires. These should be connected to the engines signal wire

BLACK wires are the Ground wires. These should be connected to the engines ground wire

WARNING: For installation of multiple outboard engines the negative battery cable for each starter motor ground circuit, must be connected to each other by a common circuit cable capable of carrying the starting current of each engines motor.

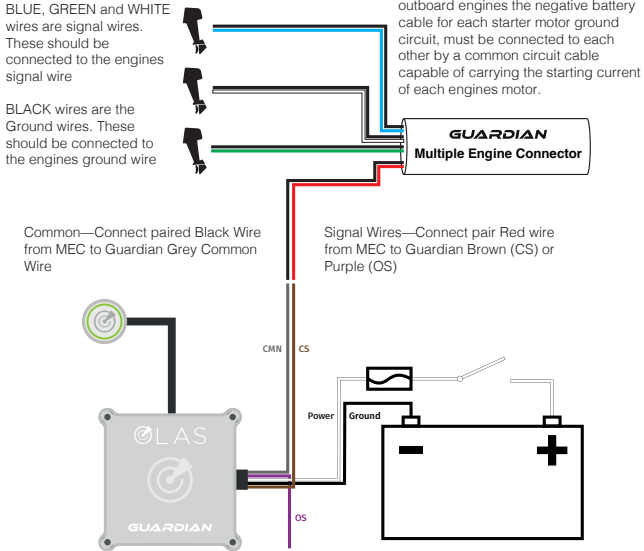

WARNING: If ONLY connecting the MEC to 2 outboard engines it is important to close off the remaining signal and ground wire with the supplied marine wire end caps.

WARNING: Always consult a trained marine electrician for correct installation of OLAS products.





INITIAL SETUP CHECK

Once the Guardian has been setup and an OLAS transmitter has been connected always **CHECK BEFORE FIRST USE.**

1. Run the engine in idle and place the OLAS transmitter at least 4 inches into open water (a cup or bucket will not be enough!) or switch off its Bluetooth transmission.
2. The engine will cut out.
3. Press the control switch once to pause the alarm.
4. After 5 seconds you will be able to operate the boat as normal.
5. Bring the OLAS transmitter back within 1 meter or switch the Bluetooth transmission back ON and press the Guardians control switch once to reconnect.
6. The Guardian can be switched off at any point by pressing the control switch for 4 seconds or when the power is disconnected. This will not stop the engine.

TECHNICAL SPECIFICATION

Weight	50g / 1.8oz
Wires	18 AWG / 0.047 (In), Tinned
Voltage Rating	300V RMS
Dimensions	210 x 20mm
Temperature Range	-20 to 80°C

CERTIFICATION AND COMPLIANCE

ABYC A-33	Compliant
RoHS2 DIRECTIVE 2011/65/EU	Compliant
REACH Regulation (EC 1907/2006)	Compliant
CE	EU Low Voltage Directive 2006/95/ EC
Outer shrink sleeve	Meets the requirements of UL 224 CSA Approved CSA 400-U-9





TERMS & CONDITIONS

Before using any OLAS wireless system it is imperative that you read the DISCLAIMER and the LIMITATION OF LIABILITY which follows. There is legal presumption that by using OLAS wireless systems you have read, understood and accepted the DISCLAIMER and the LIMITATION OF LIABILITY statement

WARNING and WARRANTY

Exposure Lights / Ultimate Sports Engineering Ltd. accept no liability for any injuries or other damages arising from the use of their product in any circumstances.

Test the Connection Whilst In Dock

Test the connection between the OLAS Receiver and the OLAS Transmitter by leaving the OLAS Receiver in its planned location and walk the OLAS Transmitter to the furthest point on the vessel. Check that all OLAS Transmitters being used are working correctly by submersing them in more than 4 inches of open water which will activate the alarm on the receiver.

Disclaimer:

OLAS wireless systems are an aid only and should be used alongside existing safety products and procedures. They should not be used for navigation or lifesaving procedures.

Limitation of Liability:

In no event shall Ultimate Sports Engineering Ltd or its members, representatives or suppliers be liable for any damages whatsoever (including, without limitation, loss of property, personal injury, death, lost revenue, lost profits, loss of goodwill, business interruption) arising from or related to the use or inability to use or reliance on any OLAS wireless system, even if Ultimate Sports Engineering Ltd or its representatives or agents have been advised of the possibility of such damages. Some jurisdictions prohibit the exclusion or limitation of liability for implied warranties or consequential damages or incidental damages, so the above limitation may not apply to you. You may have other legal rights that vary from jurisdiction to jurisdiction. To the extent any liability is found, in no event will the liability of Ultimate Sports Engineering Ltd, its members, representatives or suppliers exceed the amount paid for the OLAS wireless system inclusive of the OLAS transmitters and receivers.

Patent Notice:

The OLAS wireless systems and associated products may be covered by patents or patent pending applications.

We are here to help.

If you are experiencing any problems with your ACR OLAS product or accessories please contact our Technical Service Department

(954) 981-3333 | service@acrartex.com

Check web for additional product details and downloads: www.acrartex.com

ACR Electronics, Inc.
5757 Ravenswood Road
Ft. Lauderdale, Florida 33312
USA

